INDEX OF DRAWINGS

<u>Title</u>	<u>Number</u>
General Notes	S0.1
Typical Construction Joint Repairs	S1.0
Typical Bathtub Concrete Joint Repairs	S1.1
Typical Concrete Repairs at Utilities	S1.2
Typical Curb Repair at Stations & Misc. Repairs	S1.3
Typical Concrete Repairs at Special Trackwork	S1.4
Typical Mid Slab Concrete Repairs	S1.5

EAST MADISON AVE. TRACK REPAIRS

FROM THE WEST SIDE OF DANNY
THOMAS BRIDGE TO S WATKINS ST.

FOR

MEMPHIS AREA TRANSIT AUTHORITY
1370 LEVEE ROAD
MEMPHIS, TN 38108



3650 Thousand Oaks Blvd. - Suite 3200
Memphis, Tennessee 38118
Phone: (901) 683-3900 Fax: (901) 683-3990

FEBRUARY 2022

INDEX OF DRAWINGS

SHEET TITLE	SHEET NO.
GENERAL NOTES	BL1
TYPICAL CONSTRUCTION JOINT REPAIRS	BL2
TYPICAL SATURATED CONCRETE JOINT REPAIRS	BL3
TYPICAL CONCRETE REPAIR AT UTILITIES	BL4
TYPICAL CURB REPAIR AT STATIONS	BL5
TYPICAL CONCRETE REPAIR AT SPECIAL STRUCTURE	BL6
TYPICAL JWP SLAB CONCRETE REPAIR	BL7

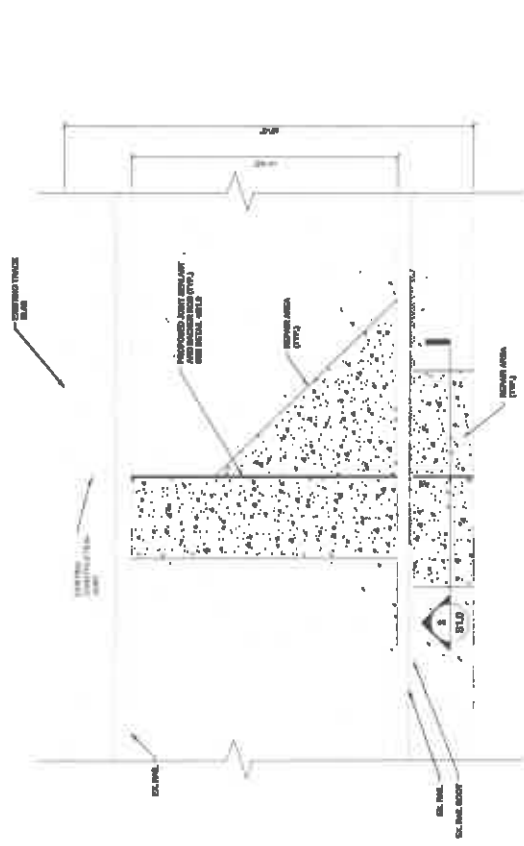

PLAN VIEW OF TYP. CONSTRUCTION JOINT CONCRETE REPAIRS
1" = 4'-0"

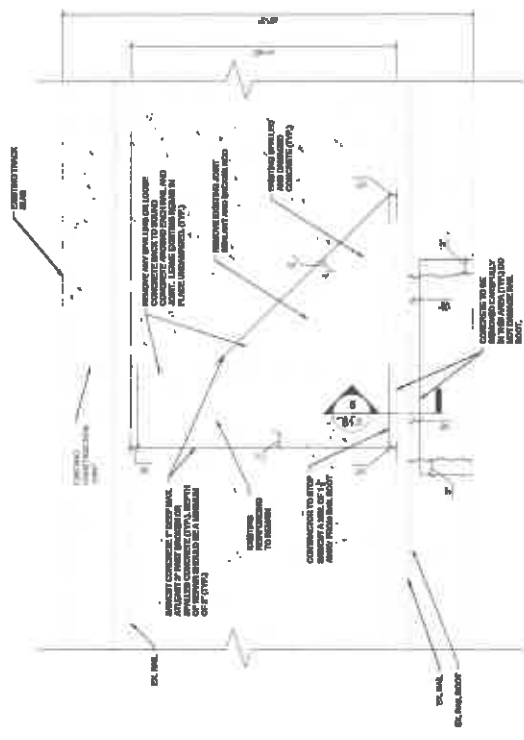

PLAN VIEW OF TYP. CONSTRUCTION JOINT CONCRETE REMOVAL
1" = 4'-0"

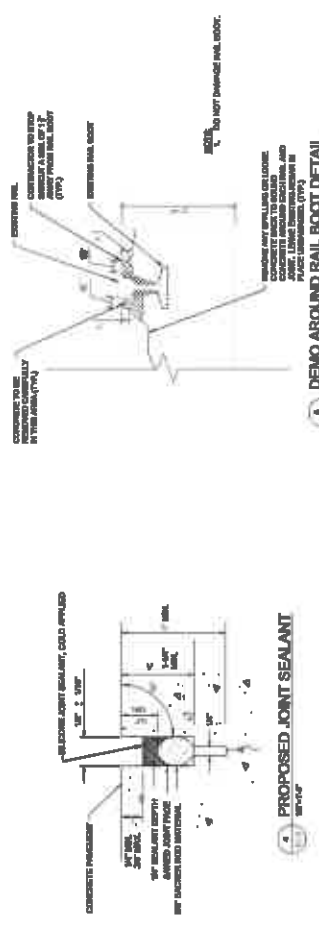

SECTION OF REPAIR
1" = 4'-0"

REPAIR TYPE | **AREA** | **UNITS** | **QUANTITY** | **REMARKS**

CONCRETE REPAIR	11 LF	CU YD	0.25	REPAIR WITH POLYMER MODIFIED CONCRETE (PVC)
CONCRETE REPAIR	11 LF	CU YD	0.25	REPAIR WITH POLYMER MODIFIED CONCRETE (PVC)
CONCRETE REPAIR	11 LF	CU YD	0.25	REPAIR WITH POLYMER MODIFIED CONCRETE (PVC)
CONCRETE REPAIR	11 LF	CU YD	0.25	REPAIR WITH POLYMER MODIFIED CONCRETE (PVC)
CONCRETE REPAIR	11 LF	CU YD	0.25	REPAIR WITH POLYMER MODIFIED CONCRETE (PVC)

NOTES:

- ALL REPAIRS SHALL BE PERFORMED IN ACCORDANCE WITH SECTION 05110 OF THE SPECIFICATIONS.
- CONCRETE SHALL BE PLACED AND FINISHED TO MATCH EXISTING CONCRETE.
- ALL REPAIRS SHALL BE APPROVED BY THE ARCHITECT PRIOR TO CONSTRUCTION.

LEGEND:

- EXISTING RAIL BOOT
- EXISTING TRACK SLAB CONCRETE
- REPAIR AREA
- PROPOSED REPAIR FOOTING
- PROPOSED CONCRETE REPAIR
- PROPOSED CONSTRUCTION MATERIAL



DATE	NOV 20 2018
PROJECT	CONCRETE JOINT REPAIRS

MADISON AVENUE TRACK REPAIRS
MATA
547 N MAIN ST, MEMPHIS, TN 38105

NO.	1
DATE	NOV 20 2018
PROJECT	CONCRETE JOINT REPAIRS
TYPICAL BATHUB CONCRETE JOINT REPAIRS	
PER CONSTRUCTION	
S11.1	

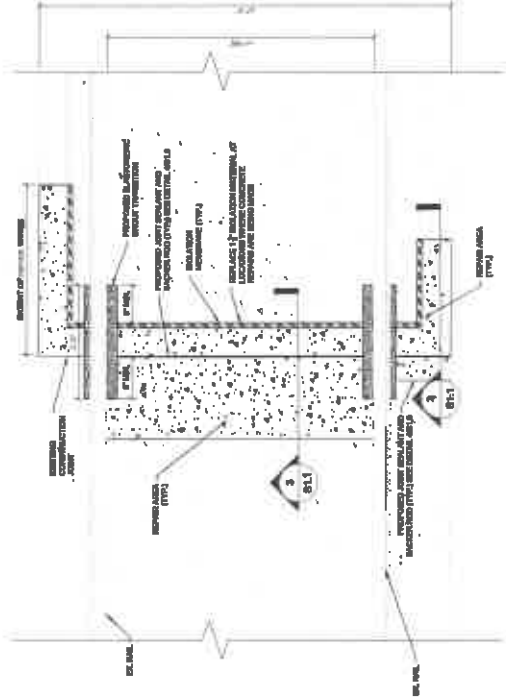

PLAN VIEW OF TYP. BATHUB CONCRETE JOINT REPAIRS

- NOTE: THE REPAIRING CONTRACTOR SHOULD COMPLETELY ENCASE THE JOINT WITH A MINIMUM COVER OF 3\"/>
 1. THE REPAIRING CONTRACTOR SHOULD COMPLETELY ENCASE THE JOINT WITH A MINIMUM COVER OF 3\"/>
 - 2. THE REPAIRING CONTRACTOR SHOULD COMPLETELY ENCASE THE JOINT WITH A MINIMUM COVER OF 3\"/>
 - 3. THE REPAIRING CONTRACTOR SHOULD COMPLETELY ENCASE THE JOINT WITH A MINIMUM COVER OF 3\"/>

LEGEND

- EXISTING TRACK BAG CONCRETE
- EXISTING JOINT
- EXISTING JOINT REPAIRS
- PROPOSED REPAIR AREA
- PROPOSED REPAIR JOINT
- PROPOSED REPAIR MATERIAL
- PROPOSED REPAIR DIMENSIONS

REPAIR TYPE	REPAIR DIMENSIONS	REPAIR MATERIAL	REPAIR COVER
REPAIR TYPE	REPAIR DIMENSIONS	REPAIR MATERIAL	REPAIR COVER
REPAIR TYPE	REPAIR DIMENSIONS	REPAIR MATERIAL	REPAIR COVER
REPAIR TYPE	REPAIR DIMENSIONS	REPAIR MATERIAL	REPAIR COVER

1. ALL REPAIRS SHALL INCLUDE APPROVAL FROM THE DESIGNER.
2. ALL REPAIRS SHALL INCLUDE APPROVAL FROM THE DESIGNER.
3. ALL REPAIRS SHALL INCLUDE APPROVAL FROM THE DESIGNER.
4. ALL REPAIRS SHALL INCLUDE APPROVAL FROM THE DESIGNER.

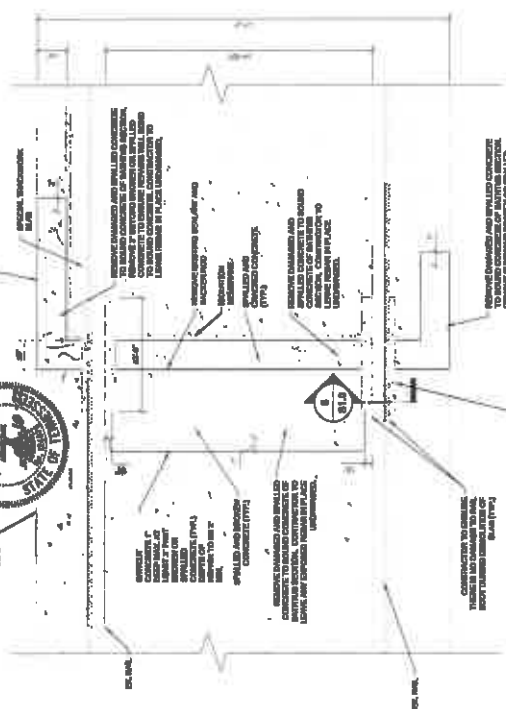

PLAN VIEW OF TYP. BATHUB CONCRETE JOINT DEMO

- NOTE: THE REPAIRING CONTRACTOR SHOULD COMPLETELY ENCASE THE JOINT WITH A MINIMUM COVER OF 3\"/>
 1. THE REPAIRING CONTRACTOR SHOULD COMPLETELY ENCASE THE JOINT WITH A MINIMUM COVER OF 3\"/>
 - 2. THE REPAIRING CONTRACTOR SHOULD COMPLETELY ENCASE THE JOINT WITH A MINIMUM COVER OF 3\"/>
 - 3. THE REPAIRING CONTRACTOR SHOULD COMPLETELY ENCASE THE JOINT WITH A MINIMUM COVER OF 3\"/>
 - 4. THE REPAIRING CONTRACTOR SHOULD COMPLETELY ENCASE THE JOINT WITH A MINIMUM COVER OF 3\"/>

SECTION OF REPAIR



1. ALL REPAIRS SHALL INCLUDE APPROVAL FROM THE DESIGNER.
2. ALL REPAIRS SHALL INCLUDE APPROVAL FROM THE DESIGNER.
3. ALL REPAIRS SHALL INCLUDE APPROVAL FROM THE DESIGNER.
4. ALL REPAIRS SHALL INCLUDE APPROVAL FROM THE DESIGNER.

SECTION OF REPAIR

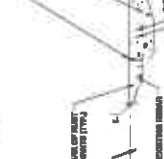

1. ALL REPAIRS SHALL INCLUDE APPROVAL FROM THE DESIGNER.
2. ALL REPAIRS SHALL INCLUDE APPROVAL FROM THE DESIGNER.
3. ALL REPAIRS SHALL INCLUDE APPROVAL FROM THE DESIGNER.
4. ALL REPAIRS SHALL INCLUDE APPROVAL FROM THE DESIGNER.



MADISON AVENUE TRACK REPAIRS
 547 N MAIN ST, MEMPHIS, TN 38105

TYPICAL CONCRETE REPAIRS AT UTILITIES

NO.	DESCRIPTION	UNIT	QUANTITY
1	FORMED CONCRETE REPAIR AT UTILITY	SF	11.2

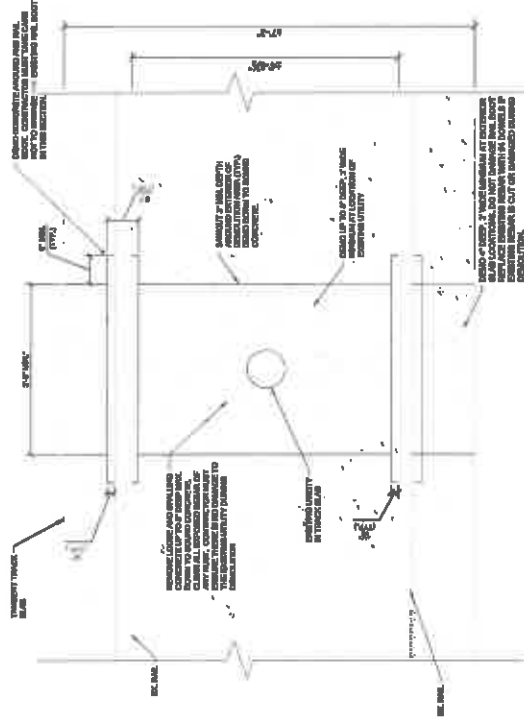

PLAN VIEW OF TYP. CONCRETE REMOVAL AT UTILITIES

REPAIR SHALL BE 2'-0" WIDE AND 2'-0" DEEP. ALL DIMENSIONS SHALL BE TO FACE UNLESS OTHERWISE NOTED.

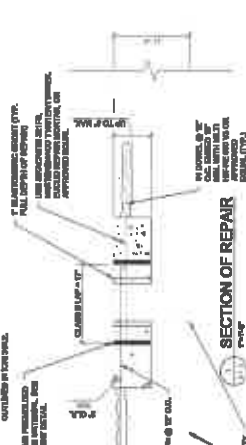

SECTION OF REPAIR

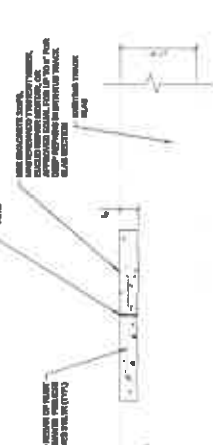

SECTION OF REPAIR

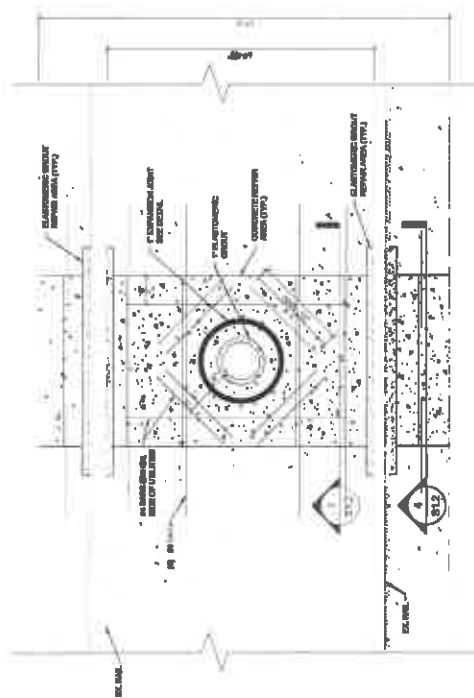

PLAN VIEW OF TYP. CONCRETE REPAIRS AT UTILITIES

REPAIR SHALL BE 1'-0" WIDE AND 1'-0" DEEP. ALL DIMENSIONS SHALL BE TO FACE UNLESS OTHERWISE NOTED.

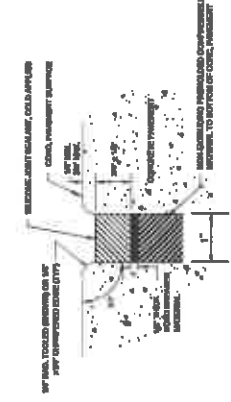

EXPANSION JOINT DETAIL



FORMED EXPANSION JOINT SEAL

LEGEND

FORMED CONCRETE REPAIR AT UTILITY	EXPANSION JOINT DETAIL
FORMED EXPANSION JOINT SEAL	RAIL BODY

1. THE ESTIMATED QUANTITIES ARE BASED ON A SITE INVESTIGATION PERFORMED ON JANUARY 4, 2022.
 2. ALL DIMENSIONS ARE TO FACE UNLESS OTHERWISE NOTED.



PROJECT NO.	DATE

MADISON AVENUE TRACK REPAIRS
 647 N MAIN ST, MEMPHIS, TN 38105

PROJECT NO.	DATE

TYPICAL CURB REPAIR AT STATIONS & MARKS (REPAIRS)

DATE: 11/11/11

BY: [Signature]

SCALE: AS SHOWN

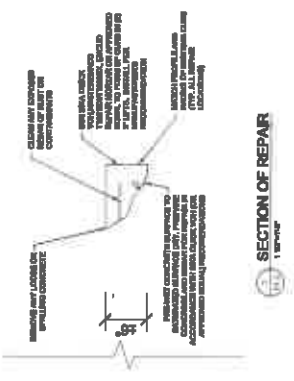

LEGEND

1. EXISTING TRACK SLAB CONCRETE
 2. PROPOSED REPAIRS

REPAIR TYPE	QUANTITY	UNIT	ESTIMATED QUANTITY	ESTIMATED COST
CONCRETE CURB AT STATION	1	LINEAR FOOT	1.00	\$1,000.00
CONCRETE CURB AT MARK	1	LINEAR FOOT	1.00	\$1,000.00
TOTAL	2	LINEAR FEET	2.00	\$2,000.00

NOTE: TRACK ESTIMATED QUANTITIES ARE BASED ON A 12" HIGH CURB. ALL QUANTITIES ARE APPROXIMATE AND SUBJECT TO FIELD VERIFICATION. ALL QUANTITIES ARE APPROXIMATE AND SUBJECT TO FIELD VERIFICATION. ALL QUANTITIES ARE APPROXIMATE AND SUBJECT TO FIELD VERIFICATION.

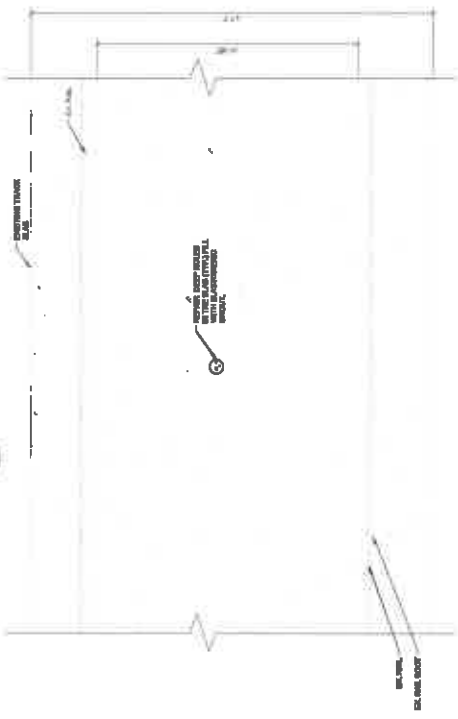
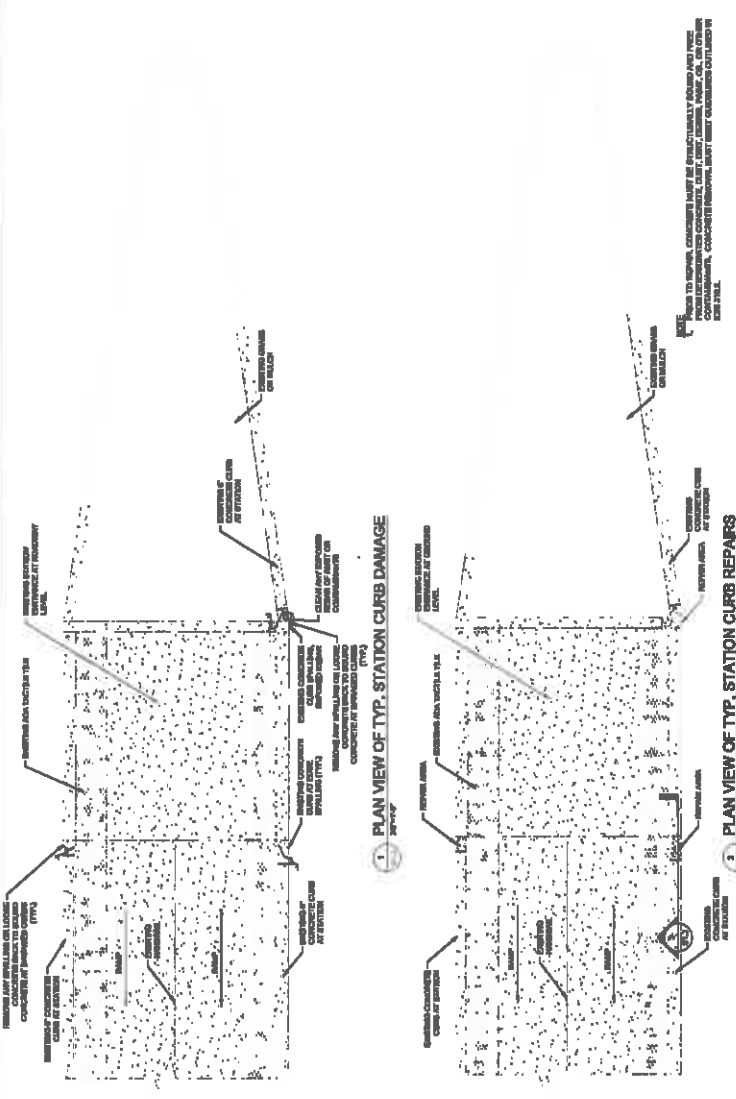

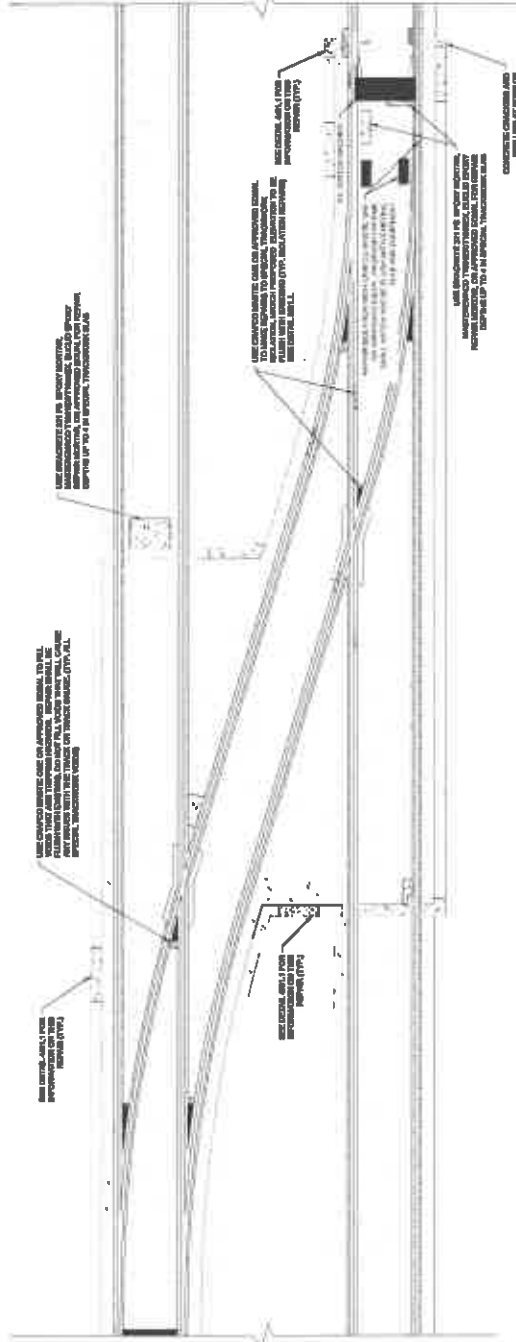
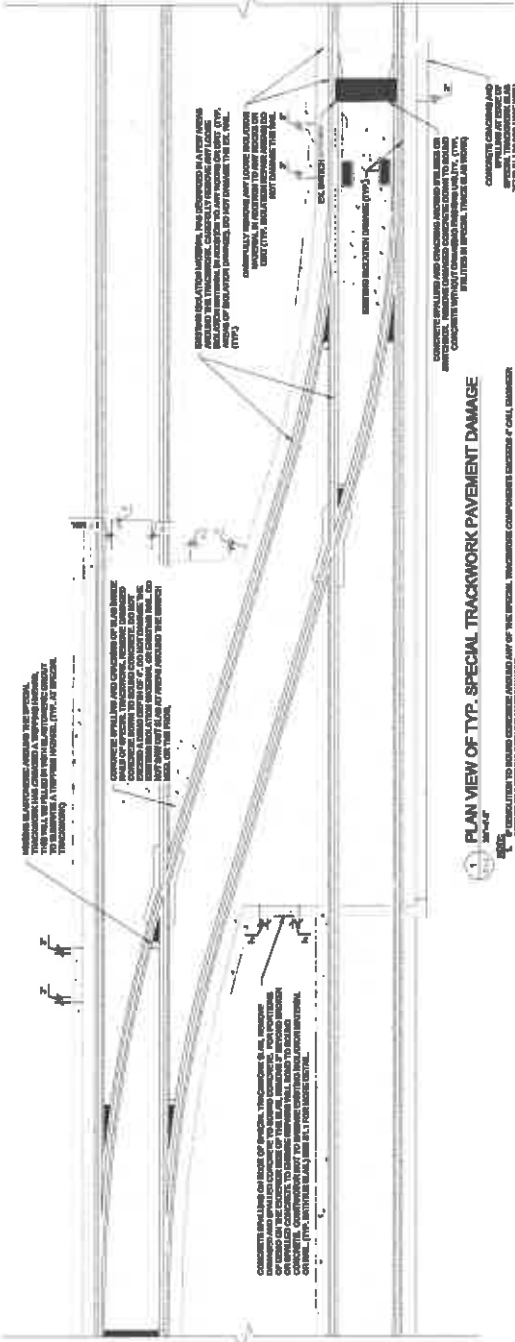

LEGEND

CONCRETE TRACKWORK REPAIRS
 REINFORCED WITH STEEL
 REINFORCED WITH FIBER
 REINFORCED WITH STEEL AND FIBER

CONCRETE TRACKWORK REPAIRS	REINFORCED WITH STEEL	100 SF
CONCRETE TRACKWORK REPAIRS	REINFORCED WITH FIBER	100 SF
CONCRETE TRACKWORK REPAIRS	REINFORCED WITH STEEL AND FIBER	100 SF

CONCRETE TRACKWORK REPAIRS SHALL BE PLACED IN ACCORDANCE WITH THE SPECIFICATIONS FOR CONCRETE IN THE CONTRACT DOCUMENTS. THE CONCRETE SHALL BE PLACED IN ACCORDANCE WITH THE SPECIFICATIONS FOR CONCRETE IN THE CONTRACT DOCUMENTS. THE CONCRETE SHALL BE PLACED IN ACCORDANCE WITH THE SPECIFICATIONS FOR CONCRETE IN THE CONTRACT DOCUMENTS.

NOTES

- ALL DIMENSIONS ARE TO BE USED IN ACCORDANCE WITH THE SPECIFICATIONS FOR CONCRETE IN THE CONTRACT DOCUMENTS. THE CONCRETE SHALL BE PLACED IN ACCORDANCE WITH THE SPECIFICATIONS FOR CONCRETE IN THE CONTRACT DOCUMENTS. THE CONCRETE SHALL BE PLACED IN ACCORDANCE WITH THE SPECIFICATIONS FOR CONCRETE IN THE CONTRACT DOCUMENTS.
- CONCRETE SHALL BE PLACED IN ACCORDANCE WITH THE SPECIFICATIONS FOR CONCRETE IN THE CONTRACT DOCUMENTS. THE CONCRETE SHALL BE PLACED IN ACCORDANCE WITH THE SPECIFICATIONS FOR CONCRETE IN THE CONTRACT DOCUMENTS. THE CONCRETE SHALL BE PLACED IN ACCORDANCE WITH THE SPECIFICATIONS FOR CONCRETE IN THE CONTRACT DOCUMENTS.

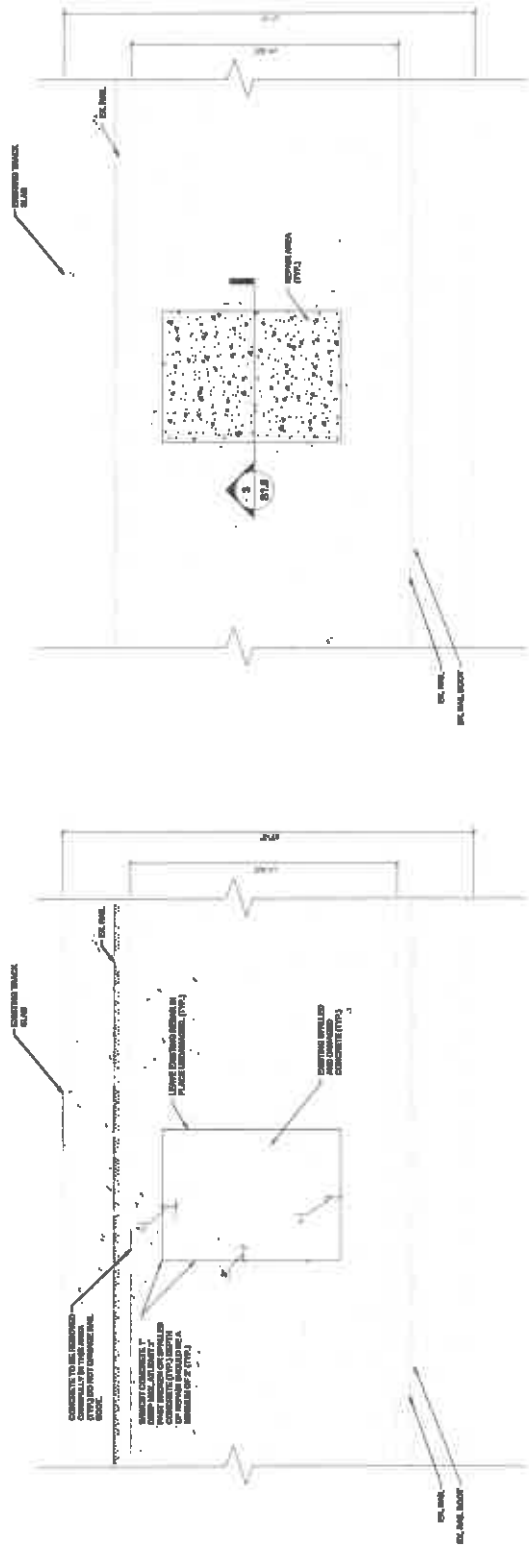

1 PLAN VIEW OF TYP. MID SLAB CONCRETE REMOVAL

2 PLAN VIEW OF TYP. MID SLAB CONCRETE REPAIRS

- NOTES:**
1. CONFIRM WITH THE ARCHITECT AND GENERAL CONTRACTOR THE EXISTING REPAIRS, REINFORCING AND THE REMOVAL OF EXISTING CONCRETE (TYP.) FROM THE TRACK REPAIRS.
 2. CONSTRUCTION IS TO BE COMPLETED WITHIN 10 BUSINESS DAYS OF THE DATE OF THE WORK ORDER.
 3. FRESH CONCRETE SHALL BE PLACED IN THE TRACK REPAIRS AND SHALL BE COMPACTED AND FINISHED TO MATCH THE EXISTING SURFACE.
 4. ALL REPAIRS SHALL BE SUBJECT TO THE APPROVAL OF THE ARCHITECT AND GENERAL CONTRACTOR.

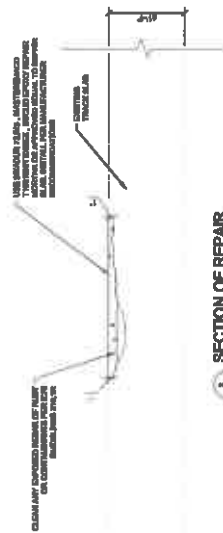

3 SECTION OF REPAIR

- NOTES:**
1. REMOVE EXISTING CONCRETE (TYP.) FROM THE TRACK REPAIRS TO THE DEPTH OF THE REPAIR.
 2. PLACE FRESH CONCRETE (TYP.) IN THE TRACK REPAIRS AND FINISH TO MATCH THE EXISTING SURFACE.
 3. ALL REPAIRS SHALL BE SUBJECT TO THE APPROVAL OF THE ARCHITECT AND GENERAL CONTRACTOR.

LEGEND

REPAIR TYPE	REPAIR QUANTITY	REPAIR UNIT	REPAIR COST	TOTAL COST
CONCRETE REMOVAL	11.000 yd³	yd³	\$110.00	\$110.00
CONCRETE REPAIR	11.000 yd³	yd³	\$110.00	\$110.00
TOTAL	22.000 yd³		\$220.00	\$220.00

1. ALL REPAIRS SHALL BE SUBJECT TO THE APPROVAL OF THE ARCHITECT AND GENERAL CONTRACTOR.
2. CONSTRUCTION IS TO BE COMPLETED WITHIN 10 BUSINESS DAYS OF THE DATE OF THE WORK ORDER.
3. FRESH CONCRETE SHALL BE PLACED IN THE TRACK REPAIRS AND SHALL BE COMPACTED AND FINISHED TO MATCH THE EXISTING SURFACE.
4. ALL REPAIRS SHALL BE SUBJECT TO THE APPROVAL OF THE ARCHITECT AND GENERAL CONTRACTOR.